

**CBC1 Series 1.27mm(.050") Dual Row Female Headers**

- ⊙ Mates with 1.27mm Pitch 0.46mm Round pin header or 0.40mm Square pin header
- ⊙ High performance contact design
- ⊙ For 0.8mm Thickness P.C Board Clip
- ⊙ Low insertion Force , Anti-flux
- ⊙ With PCB pegs options

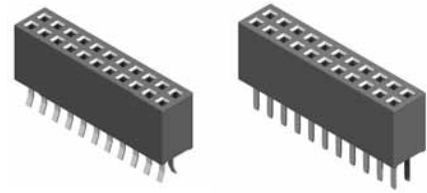

PCB CLIP TYPE

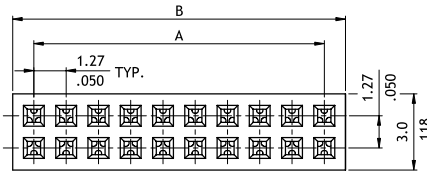

A = 1.27 X No. of Spaces  
B = A + 1.67

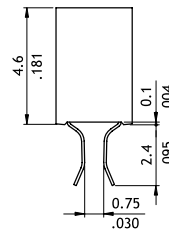
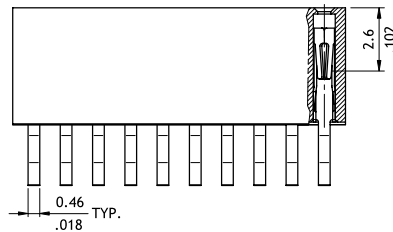

DIP TYPE

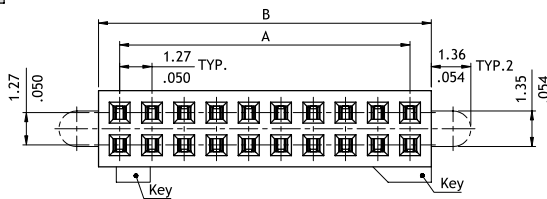

A = 1.27 X No. of Spaces  
B = A + 1.67  
C = A + 3.05

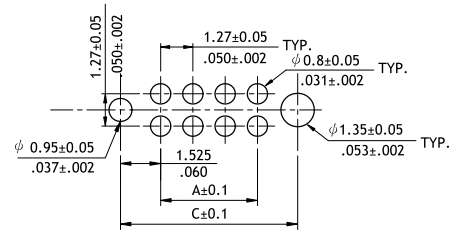
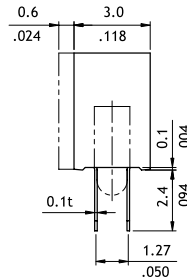
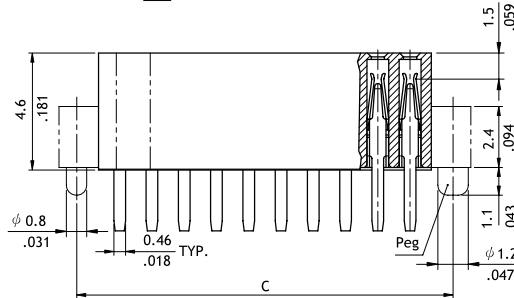

Recommended P.C. Board Layout

**Ordering Code**

**1**      **2**      **3**      **4**      **5**      **6**  
**CBC1 60 2 D 1 00**

- |   |  |  |
|---|--|--|
| <p><b>1</b> Series No.</p> <p><b>2</b> Circuits:<br/>with keys:<br/>10,20,30 ~60<br/>without keys:06~60</p> | <p><b>3</b> Plating code:<br/>A= Selective Gold flash over Nickel (CLIP Type)<br/>2= Gold flash over Nickel (DIP Type)</p> <p><b>4</b> Tail Style:<br/>C= PCB CLIP<br/>(Mates with 1.27mm Pitch 0.46mm Round pin header)<br/>D= DIP Type<br/>(Mates with 1.27mm Pitch 0.4mm Square pin header)</p> | <p><b>5</b> Insulator Color :1= Black</p> <p><b>6</b> Other options:<br/>PCB CLIP Type:<br/>00= Standard<br/>DIP Type:<br/>00= Without Key and peg<br/>10= With Key and Pegs<br/>20= Without Key and with Pegs</p> |
|---|--|--|